

Section X-X  
1:20

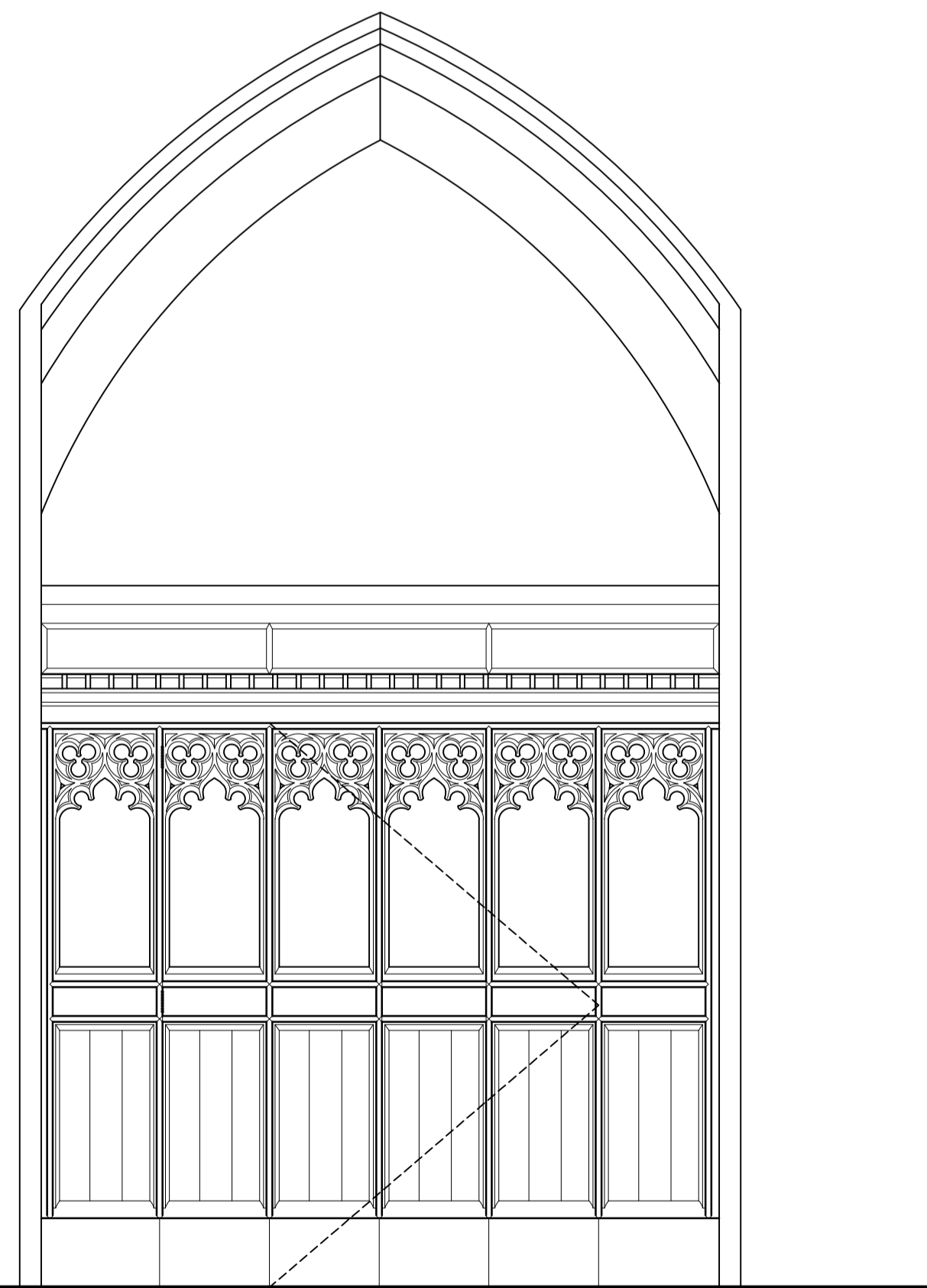

Tower as seen from East  
1:20

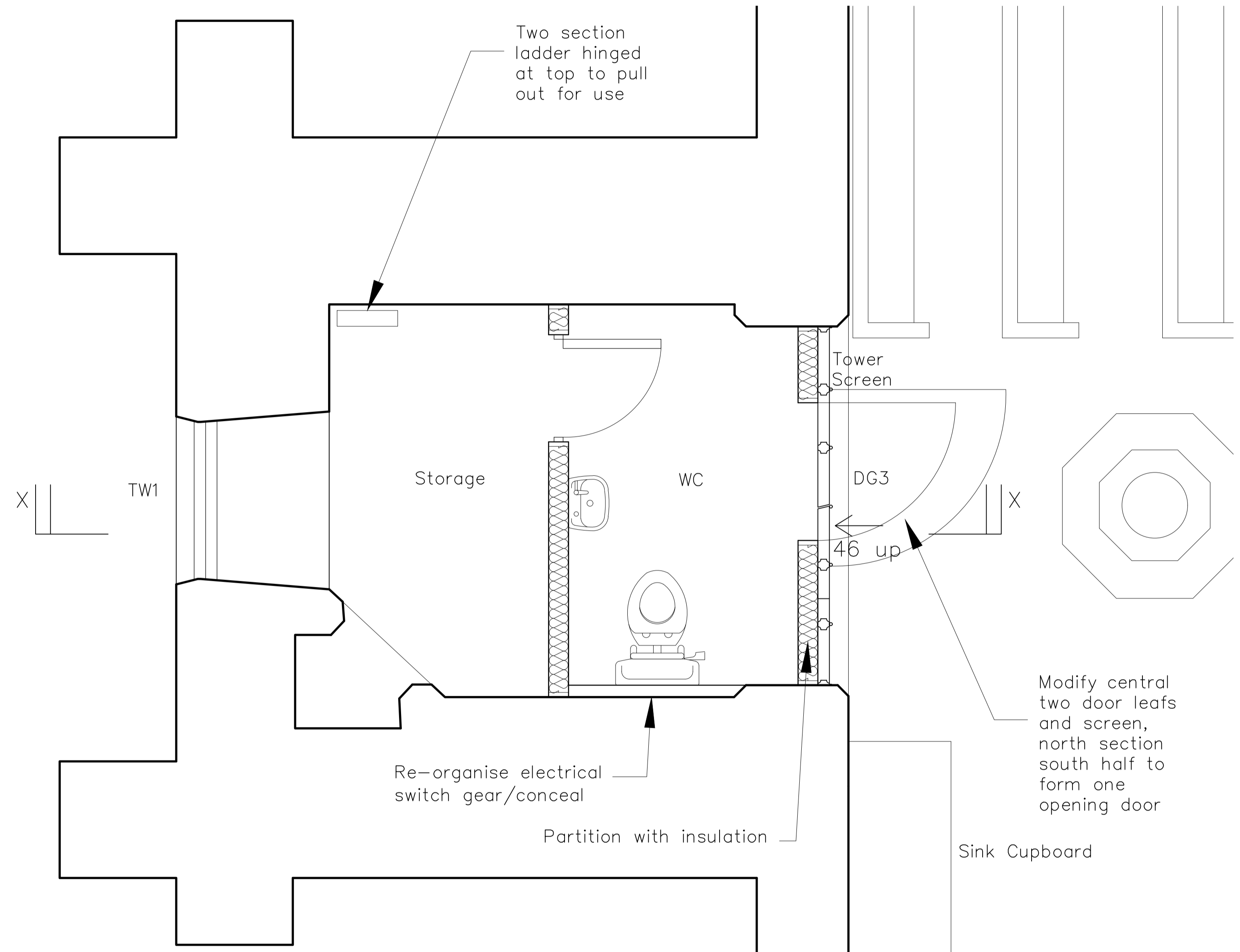

Tower Plan  
1:20

Revisions:

Client: Church Wardens and PCC

Job Title: St Mary the Virgin, Kentford

Drawing Title: Proposed tower plan & section

Scale: 1:20 @ A1      Drawn By: NC/DK      Date: Nov 2020

Job Number: C208/2      Drawing Number: 11

**WCP** THE WHITWORTH CO-PARTNERSHIP LLP  
CHARTERED ARCHITECTS AND SURVEYORS

18 Hatter Street, Bury St Edmunds, Suffolk, IP33 1NE  
T: 01284 760421 F: 01284 704734 info@whitcp.co.uk www.whitcp.co.uk

NOTE:  
Do not scale from this drawing. Confirm all dimensions on site. Refer any discrepancies to the Architect before work is put in hand. Read this drawing in conjunction with the relevant sections of the specification, schedule of works and other drawings.

This drawing is copyright of The Whitworth Co-Partnership LLP.

